

**LOWRY 6TH AVE
 SUNDIAL GNOMON**
 LOWRY REDEVELOPMENT AUTHORITY
 DENVER, CO

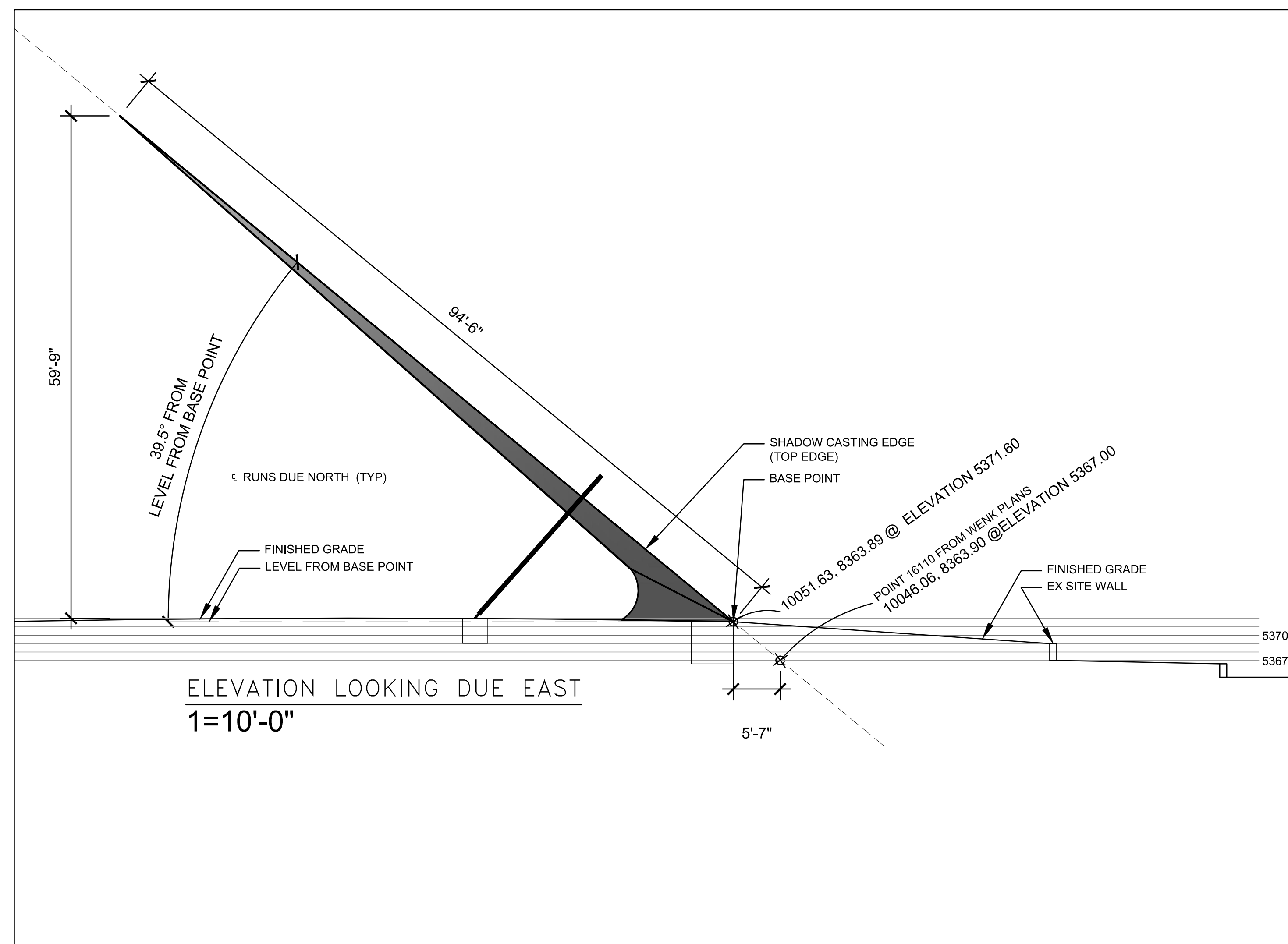
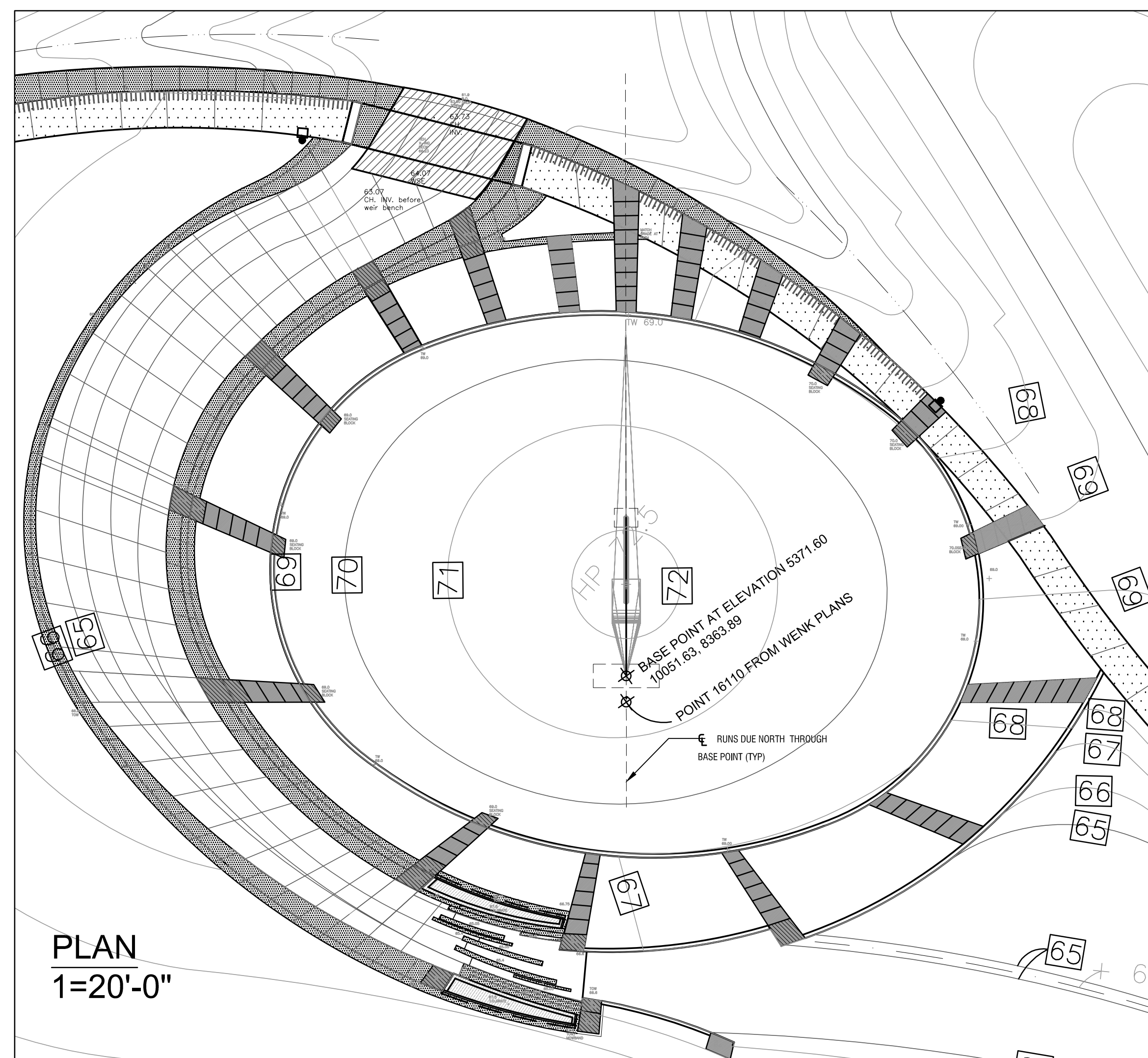

REVISIONS:

#	DATE	DESCRIPTION

PROJECT INFO:
 PROJECT NUMBER: **0000**
 DESIGNED BY: **JMC**
 DRAWN BY: **JMC**
 REVIEWED BY: **JMC**

DATE: **JUNE 24, 2011**
 ISSUE: **CD SET**
 SHEET TITLE: **GNOMEN LAYOUT PLAN**
 SHEET NUMBER: **L1.0**

PROGRESS SET:
 NOT FOR CONSTRUCTION
 These documents are incomplete,
 are released for interim review only,
 and are not intended for regulatory
 approval, bidding, permit, or
 construction purposes.

DRAWING SCALE
AS INDICATED

FILE MANAGEMENT:
 FILE NAME: S:\LRA\Sundial2 DESIGN\07 CAD\01 CONCEPT_MASTERPLAN\Xbases\SDLA.GREATLAWN.SUNDIAL.dwg
 PCP FILE: STREAM\luppers.PCP
 PLOT DATE: June 29, 2011
 THIS DRAWING IS CURRENT AS OF PLOT DATE AND MAY BE SUBJECT TO CHANGE.

**LOWRY 6TH AVE
 SUNDIAL GNOMON**
 LOWRY REDEVELOPMENT AUTHORITY
 DENVER, CO

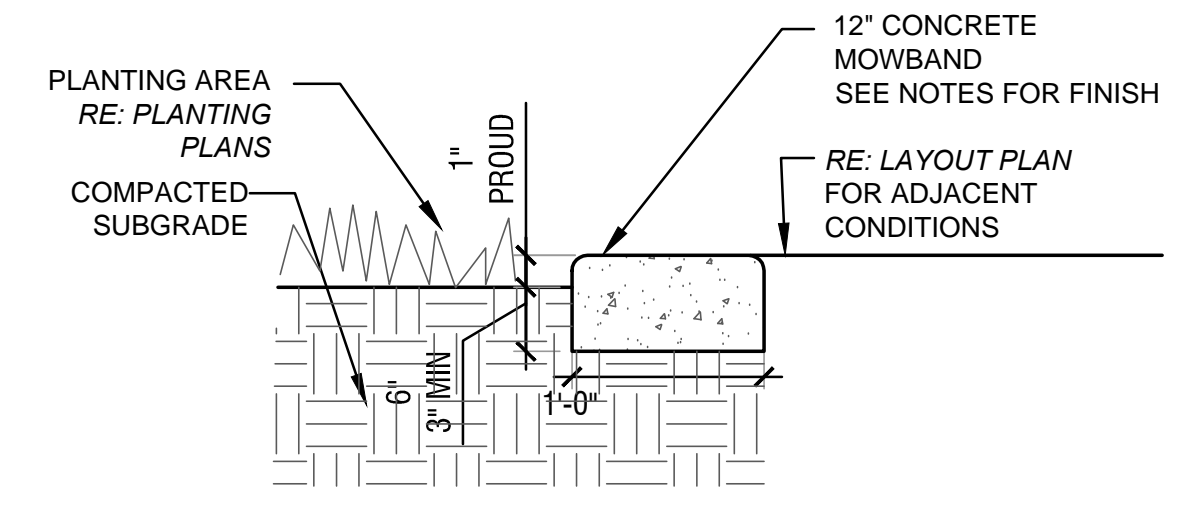

- NOTES:**
1. FINISHES AND COLOR TO MATCH SAND FINISH OF WALLS AT EXISTING SUNDIAL AREA. USE GRACE WUOODUVAE -AUUUEUUUXXOOOUWDS SURFACE RETARDER.
 2. REFERENCE LAYOUT SHEET FOR LAYOUT INFO
 3. MATCH GRADES OF EXISTING ADJACENT GRADES.
 4. MOWEDGE TO BE 1" PROUD OF F.G. IF TURF OR PLANTING AREA AND FLUSH TO ADJACENT PAVING.
 5. CONTRACTOR SHALL VERIFY ELEVATIONS, PRODUCTS, AND TECHNICAL DATA WITH OWNER'S REPRESENTATIVE PRIOR TO CONSTRUCTION.
 6. IN AREAS WHERE CONCRETE FOUNDATION IS LESS THAN 6" BELOW FINISHED GRADE, POUR MOWBAND DIRECTLY ON TOP OF CONCRETE FOUNDATION TO RESULT IN AN EVEN AND LEVEL TOP SURFACE OF MOWBAND. MOWBAND PAVING SHALL BE A MINIMUM OF 3" THICK IF POURED OVER FOUNDATION.

1 6" CONCRETE MOWBAND
 SCALE: NTS SECTION

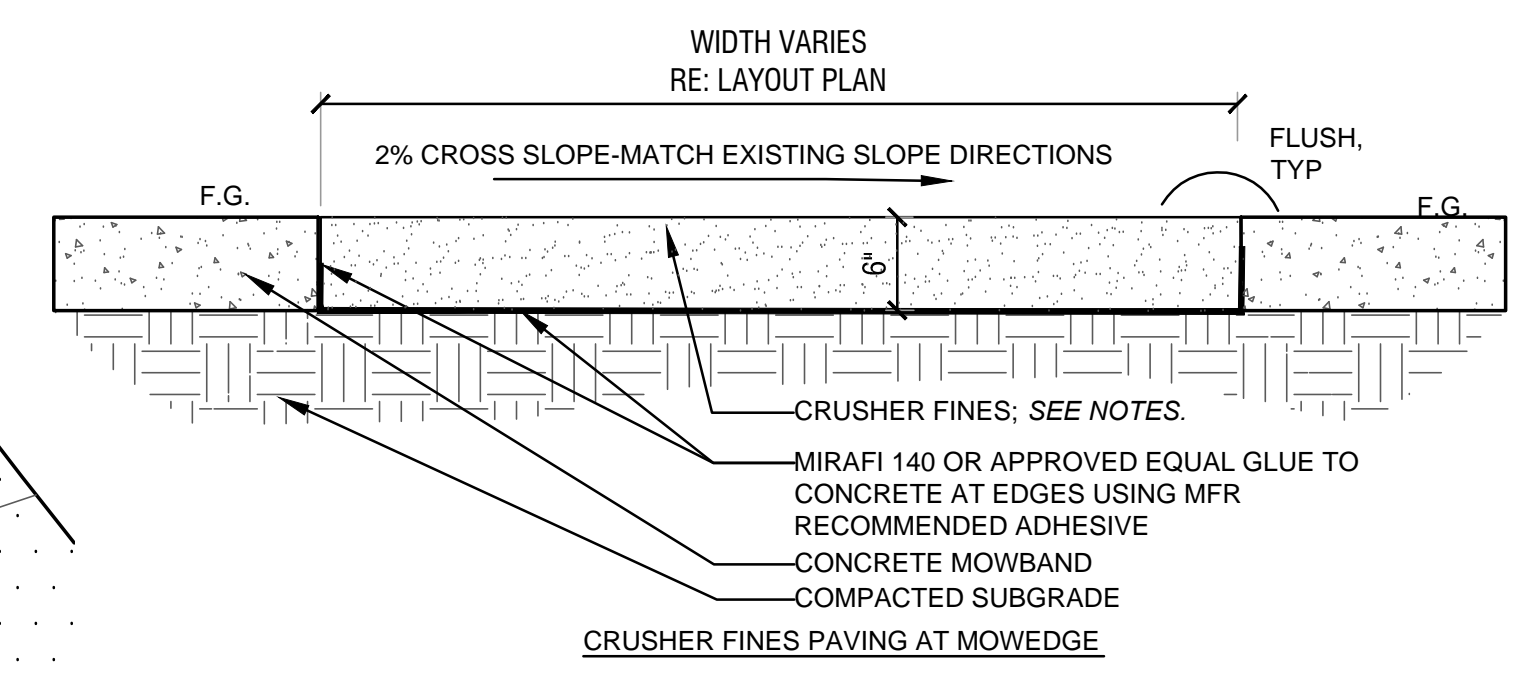

- NOTES:**
1. CRUSHER FINES PAVING SHALL BE PLACED IN (2) 3" LIFTS MIN.
 2. INSTALL CRUSHER FINES PAVING FLUSH WITH ADJACENT MOWBAND, TYP.
 3. CRUSHER FINES IN AREAS STEEPER THAN 3% SHALL BE STABILIZED USING AN APPROVED INTEGRALLY MIXED PRODUCT.

2 CRUSHER FINES PAVING
 SCALE: NTS SECTION

- NOTES:**
1. THE CONTRACTOR SHALL REPAIR IRRIGATION TO IRRIGATE AROUND THE MOW BAND, CRUSHER FINES, AND GNOMON INSTALLATION USING POP UP AND/OR ROTOR TYPE HEADS. ALL IRRIGATION REPAIRS SHALL MATCH EXISTING SYSTEM IN PARTS AND MATERIALS AND SHALL PROVIDE HEAD TO HEAD COVERAGE FOR TURF AND PLANTING AREAS.
 2. IN-GROUND UP-LIGHTING TO BE COORDINATED TO INTEGRATE INTO MOW BAND OR PAVING AREA.

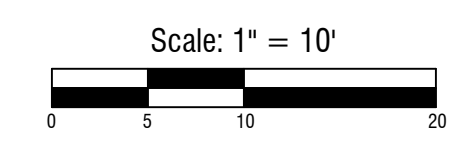
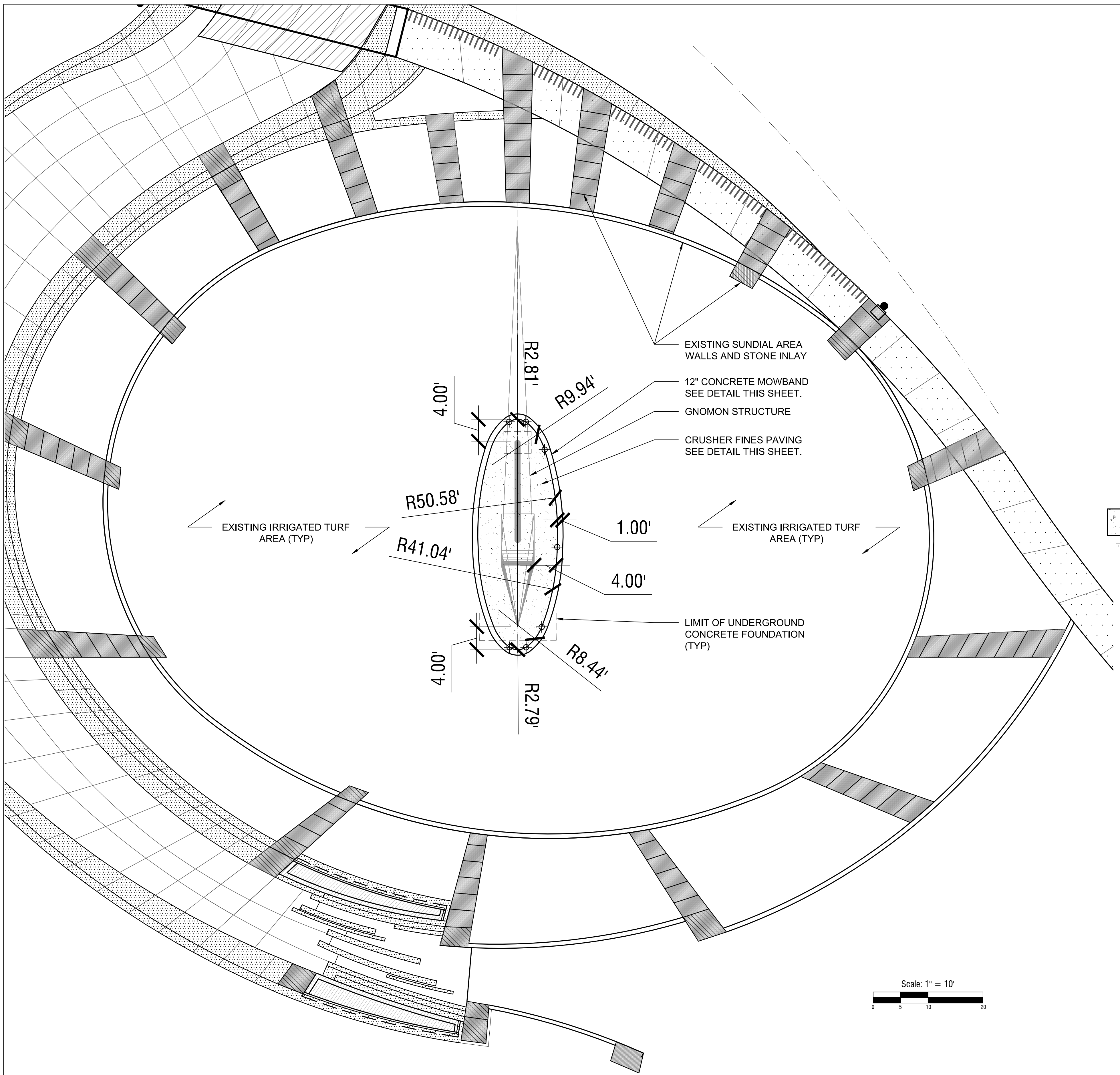

REVISIONS:

#	DATE	DESCRIPTION

PROJECT INFO:
 PROJECT NUMBER: **00000**
 DESIGNED BY: **JMC**
 DRAWN BY: **JMC**
 REVIEWED BY: **JMC**

DATE: **JUNE 24, 2011**
 ISSUE: **CD SET**
 SHEET TITLE: **LANDSCAPE LAYOUT PLAN**
 SHEET NUMBER: **L2.0**

PROGRESS SET:
NOT FOR CONSTRUCTION
 These documents are incomplete, are released for interim review only, and are not intended for regulatory approval, bidding, permit, or construction purposes.

DRAWING SCALE
AS INDICATED

FILE MANAGEMENT:
 FILE NAME: S:\LRA-Sundial\2 DESIGN\07 CAD\01 CONCEPT_MASTERPLAN\Xbases\SDLA.GREATLAWN SUNDIAL.dwg
 PCP FILE: STREAM\luppers.PCP
 PLOT DATE: June 28, 2011
 THIS DRAWING IS CURRENT AS OF PLOT DATE AND MAY BE SUBJECT TO CHANGE.

THE STRUCTURAL ENGINEER'S SEAL ON THIS DRAWING INDICATES THAT THE INFORMATION SHOWN AND THE CALCULATIONS PERTAINING TO THAT INFORMATION HAVE BEEN PREPARED BY CALIBRE ENGINEERING UNDER THE SUPERVISION OF REGISTERED PROFESSIONAL ENGINEERS. CALIBRE ENGINEERING DOES NOT ACCEPT RESPONSIBILITY FOR INFORMATION PREPARED BY OTHERS NOR FOR ANY INFORMATION NOT SHOWN ON THIS DRAWING AND SUCH RESPONSIBILITY IS SPECIFICALLY DISCLAIMED. ON FINISHED PROJECTS, DRAWINGS THAT ARE ISSUED BUT NOT SEALED MAY BE ISSUED FOR INFORMATION ONLY. THESE DRAWINGS ARE TO BE USED IN CONJUNCTION WITH THE ARCHITECTURAL DRAWINGS ON THE PROJECT TO CLEARLY DEFINE ALL OF THE REQUIREMENTS FOR THE CONSTRUCTION. WHERE CONFLICTS OCCUR CONTACT ARCHITECT FOR CLARIFICATION. COPYRIGHT © 2017 KLEA, INC.

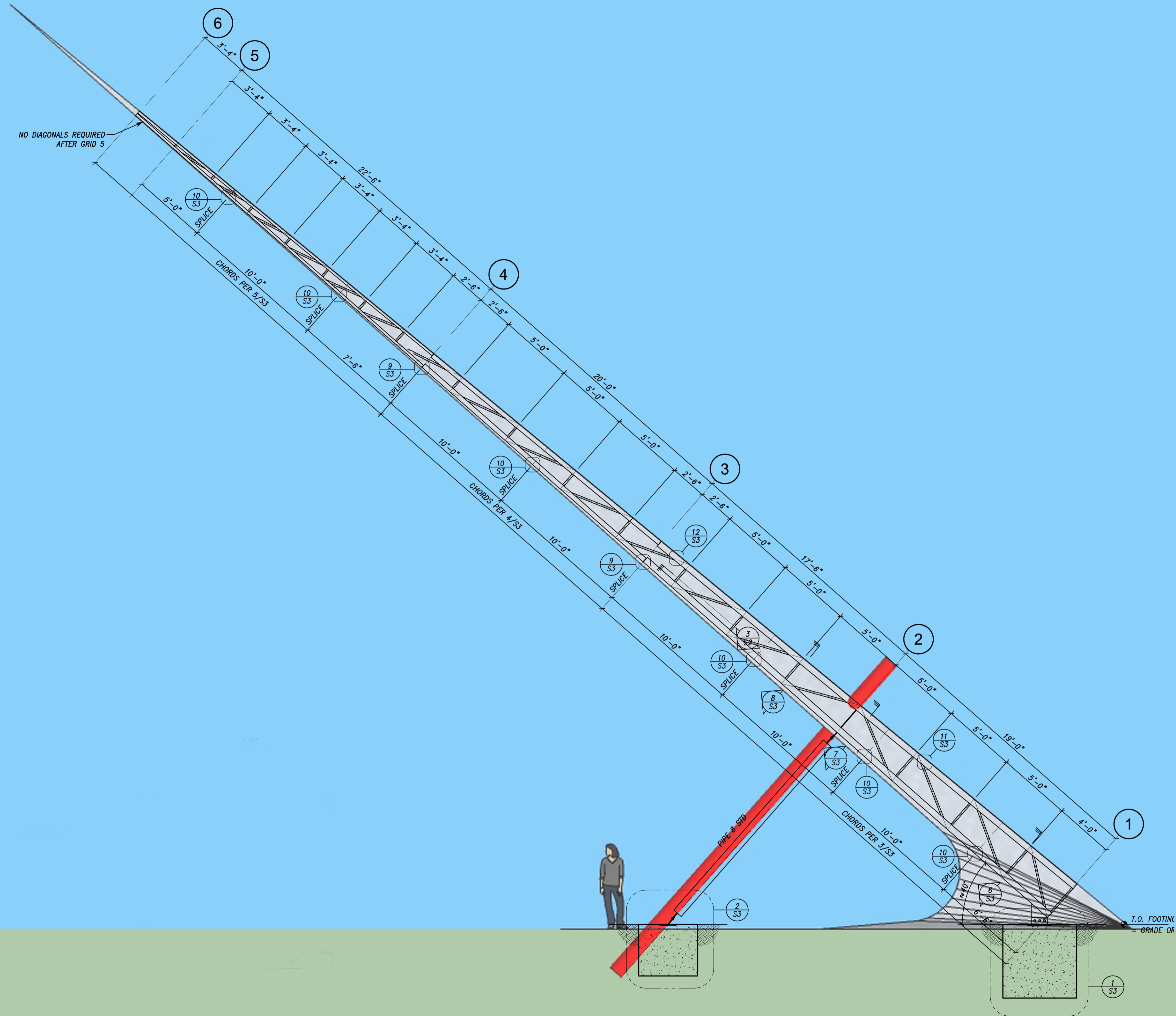

2

ELEVATION

SCALE : 1/4" = 1'-0"

NOTES:

1. ALUMINUM SKIN (BY OTHERS) SHOULD NEVER DIRECTLY COME IN CONTACT WITH STRUCTURAL STEEL.

1

FOOTING

SCALE : 1/4" = 1'-0"